

# CONTENTS

<b>CRANKS/</b>	<b>/01</b>
<b>CHAINRINGS/</b>	<b>/03</b>
<b>PEDALS/</b>	<b>/10</b>
<b>GRIPS/</b>	<b>/13</b>
<b>OEM SERVICE/</b>	<b>/19</b>



# ROAD Cranks

## BB386



### C-101

AL7075 FULL CNC

Spindle: 30mm

BCD: 110/130mm

Length: 165/170/175mm

Weight: 610g(170mm)



### C-102

AL7075 FULL CNC

Spindle: 30mm

BCD: 110mm

Length: 165/170/175mm

Weight: 609g(170mm)

*BB386 system is a revolutionary innovation, using the proven 30mm alloy spindle, which already is known to reduce weight and improve stiffness. It simply modifies the BB30 design to a wider width and incorporates a press fit bearing cup, rather than the direct fit bearing of the BB30 system.*

# MTB Cranks

## BB386

### **C-131SD**(for single/double)

AL7075 FULL CNC

Spindle: 30mm

BCD: 104mm

Length: 165/170/175mm

Weight: 682g(170mm)



### **C-131T**(for triple)

AL7075 FULL CNC

Spindle: 30mm

BCD: 104/64mm

Length: 165/170/175mm

Weight: 656g(170mm)



*It could also be used on threaded BB shells, thanks to the threaded reducer cups for 30mm spindles. Moreover, it will also offer greatly improved performance compared to 24mm integrated systems.*

# Chainrings

## Pure Oval

Our oval chainring is a *PURE* oval shape, not a dual-oval or other shapes. Pure oval shape and the power delivery through a pedal stroke match perfectly, not only optimize the power output in peak power zone, but also minimize the loads on knee joints in weak power zone.

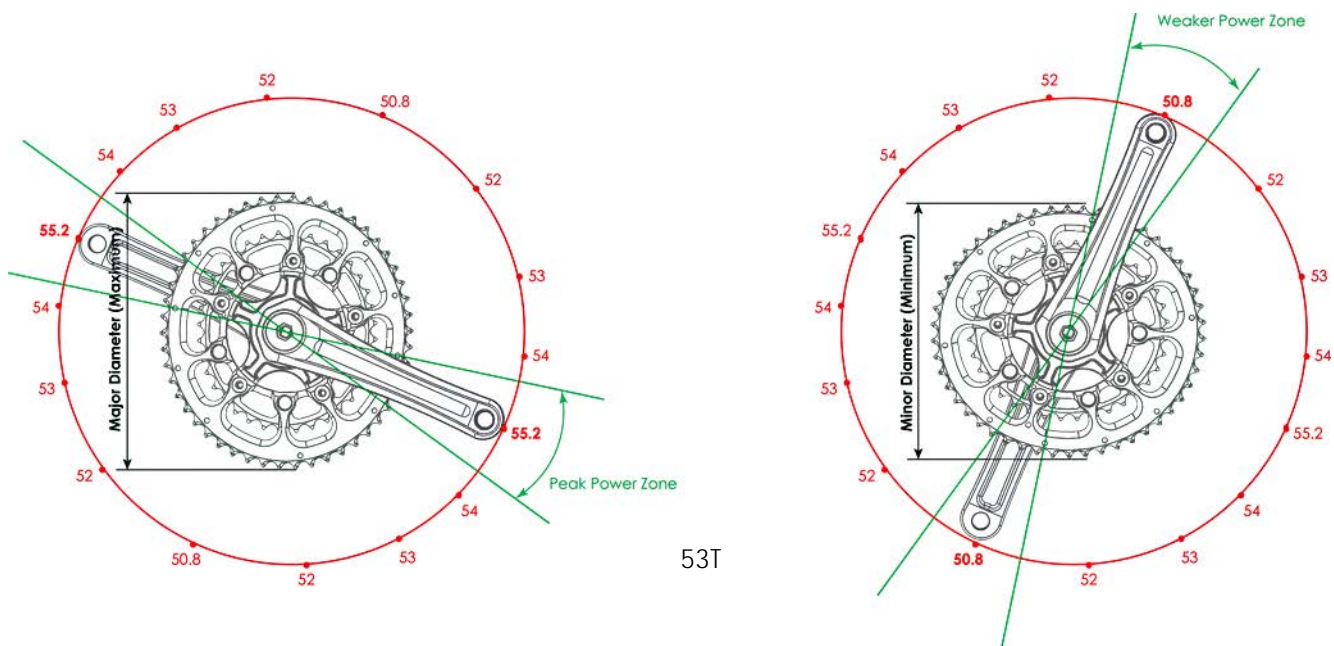

## Precise Orientation(timing) Setting

According to the most cyclists' experience, the optimum orientation is not fixed, as it depends on the different pedaling conditions, such as level terrain or climbing, pedaling seated or standing up, or the preference for pedaling at a faster or slower cadence. However, it doesn't make sense to have too many mounting points to choose as it is not possible for cyclists to adjust the mounting angle during the riding. Our oval chainrings have the most precisely mounting angle that is got from many tests, suiting for all kinds of riding conditions.

# Road Chainrings



## **E2-01**

AL7075 FULL CNC

Teeth: 53/39T(BCD:130mm)

50/34T, 52/36T(BCD:110mm)

Weight: 153g(50/34T)



**5** bolts + **4** bolts

## **E2-09**

AL7075 FULL CNC

Teeth: 50/34T, 52/36T, 53/39T

Weight: 153g(50/34T)



For normal 110 BCD  
(SRAM Red/Force/Rival, FSA ...) Cranks



For Shimano 110 BCD Asymmetric 4-bolt cranks

# Mini-Velo Chainrings



NEW

## **R1-13**

AL7075 FULL CNC

BCD:130mm

Teeth: 70T

Weight: 293g





# Narrow/Wide Chainrings

## *Chain Engagement Technology*

*Utilizing "Narrow-Wide" technology, these chainrings are designed with teeth specific to the male and female parts of your chain, which guarantees maximum chain retention in the harshest of conditions. Perfect for your 1x9, 1x10, 1x11 and 1x12 drivetrain, the narrow wide chainrings are nearly universal for any MTB application. The long wearing 7075 aluminum is durable and impact resistance, reducing the chance of bent or broken teeth.*

## *The Patent*

*Narrow-Wide chainring's concept is based on an US patent back in 1979 and originally intended for agriculture use. Many companies use it on MTB due to its great chain retention function. In order to stand out from the market, UFOR develops the unique design on the surface contour and has the design patent.*

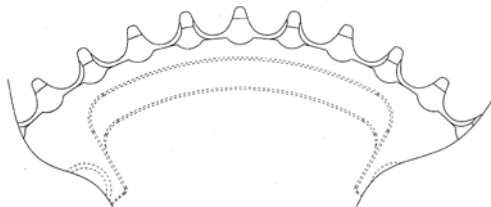

*Making it simpler, lighter and quieter!!*

# MTB N/W Single Chainrings



## **E1-03**

*Fit any 104 BCD Crank*

*AL7075 FULL CNC*

*BCD: 104mm*

*Teeth: 34/36/38T*

*Weight: 45g(34T)*

*Compatibility: 9/10/11/12 speed*



## **E1-06**

*Fit XT M8000*

*AL7075 FULL CNC*

*BCD: 96mm*

*Teeth: 32/34/36/38T*

*Weight: 49g(34T)*

*Compatibility: 9/10/11/12 speed*



## **E1-07**

*Fit XTR M9000*

*AL7075 FULL CNC*

*BCD: 96mm*

*Teeth: 32/34/36/38T*

*Weight: 45g(34T)*

*Compatibility: 9/10/11/12 speed*



### E1-04

Direct Mount(3mm offset)

AL7075 FULL CNC

Teeth: 28/30/32/34/36T

Weight: 74g(32T)

Compatibility: 9/10/11/12 speed



### E1-05

Direct Mount(6mm offset)

AL7075 FULL CNC

Teeth: 28/30/32/34/36T

Weight: 73g(32T)

Compatibility: 9/10/11/12 speed



### E1-21/R1-21

Direct Mount(3mm offset)

For Shimano

AL7075 FULL CNC

Teeth: 28/30/32/34/36T

Weight: 76g(32T)

Compatibility: 9/10/11/12 speed



### R1-11/R1-12

Direct Mount(3mm/6mm offset)

AL6061

Teeth: 28/30/32/34/36T

Weight: 81g(34T)

Compatibility: 9/10/11/12 speed

# MTB Chainrings



## **E2-03**

AL7075 FULL CNC

BCD: 104/64mm

Teeth: 38/24T

36/22T

Weight: 76g(36/22T)



## **E3-03**

AL7075 FULL CNC

BCD: 104/64mm

Teeth: 42/33/24T

Weight: 148g

*Close ratio gear combination - 42-33-24T -  
makes shifting smoother and faster*



# Commuter Pedals

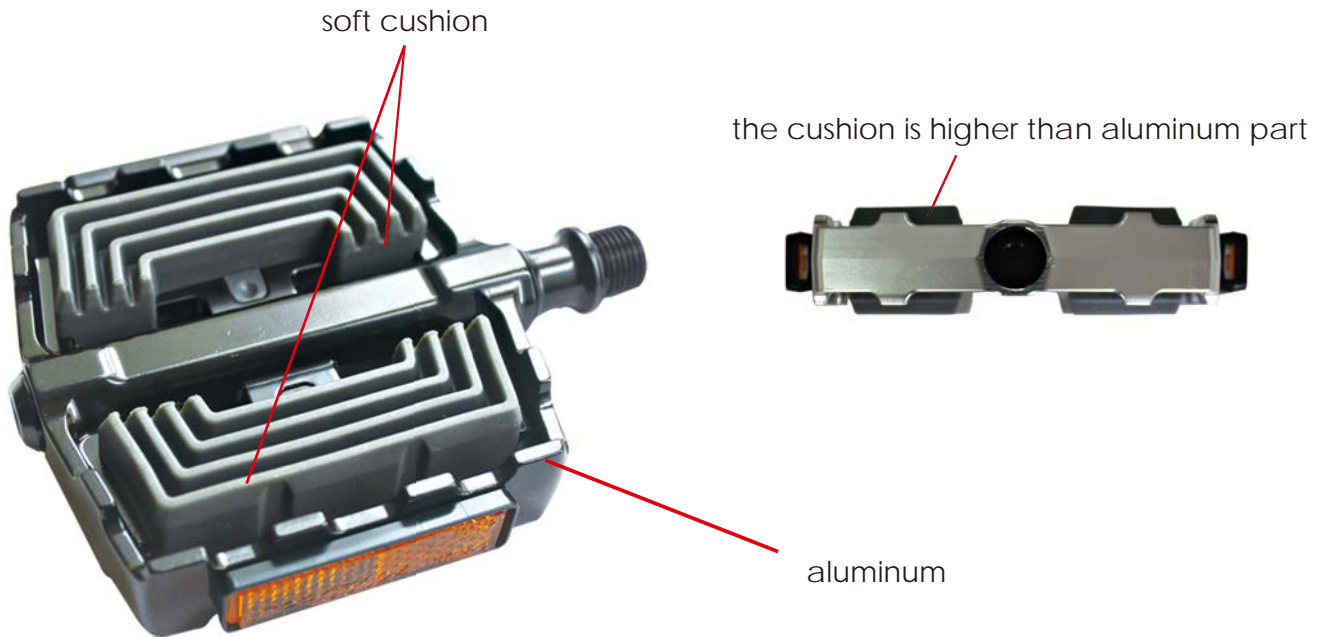

## **UF-351**

*Die Casting ADC10 aluminum + Shore 35A rubber cushion*

*CNC-machined Cr-Mo axle*

*LSL bushing & sealed bearing*

*Platform size : 100 x 100 x 17.5mm*

*Electro-deposition surface treatment*

*Weight: 504g/pair*

*Intended use: EMTB, Pedelects and commute bikes*

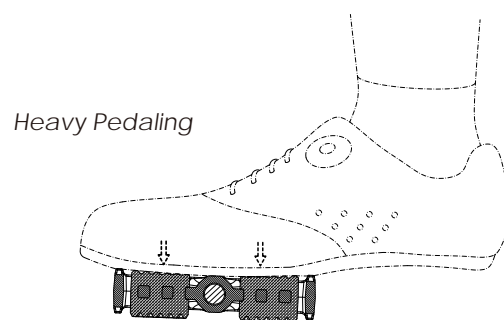
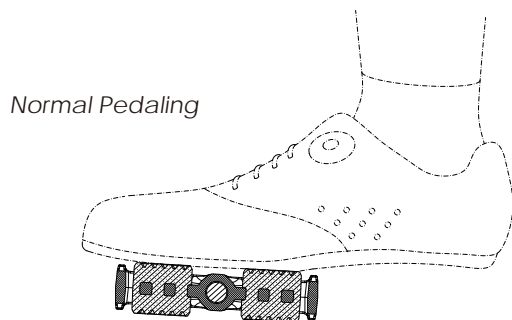

# MTB Flat Pedals



## **UF-303**

6061 aluminum, CNC-machined  
CNC-machined Cr-Mo Axle  
Bushing & Sealed Bearing  
Size: 100 x 105 mm  
Weight: 380g/pair



## **UF-305**

6061 aluminum, CNC-machined  
CNC-machined Cr-Mo Axle  
Bushing & Sealed Bearing  
Size: 95 x 100 mm  
Weight: 392g/pair



## **UF-304(thin/light)**

6061 aluminum, CNC-machined  
CNC-machined Cr-Mo Axle  
LSL Bushing & Double Sealed Bearing  
Size: 100 x 105 mm  
weight: 297g/pair



## **UF-306(thin/light)**

6061 aluminum, CNC-machined  
CNC-machined Cr-Mo Axle  
LSL Bushing & Double Sealed Bearing  
Size: 100 x 105 mm  
weight: 297g/pair

**NEW**

# MTB Clipless Pedals

NEW

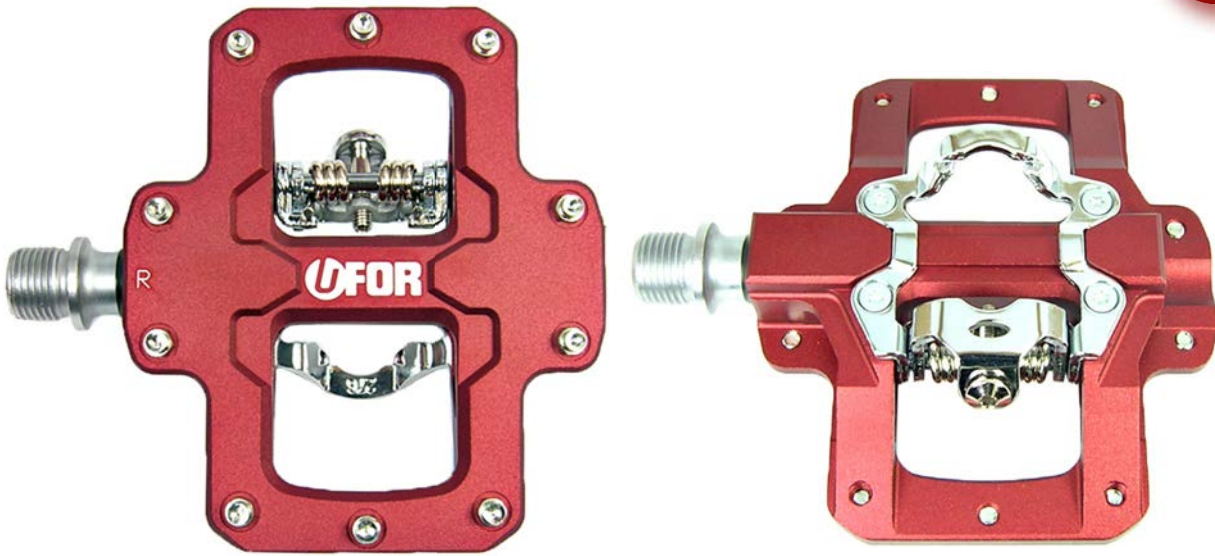

## **UF-310**

*Extruded, CNC-machined body, AL6061*

*CNC-machined Cr-Mo axle*

*LSL bushing and sealing bearing*

*Size: 100 x 88 mm*

*Weight: 406g per pair with pins*

# Road Pedals



## **UF-201**

*CNC-machined Cr-Mo axle*

*LSL bushing and sealing bearing*

*Size: 95 x 53 x 21mm*

*Weight: 220g per pair with pins*

# Hexa-Ring Locking System

## **Hexa-Ring Locking System**

*This is a brand new locking system, with revolutionary structure, concept and shape to be totally different from the traditional round-ring system. It also features an ingenious groove integrating with corresponding rib on the inner tube to prevent the ring from coming off.*

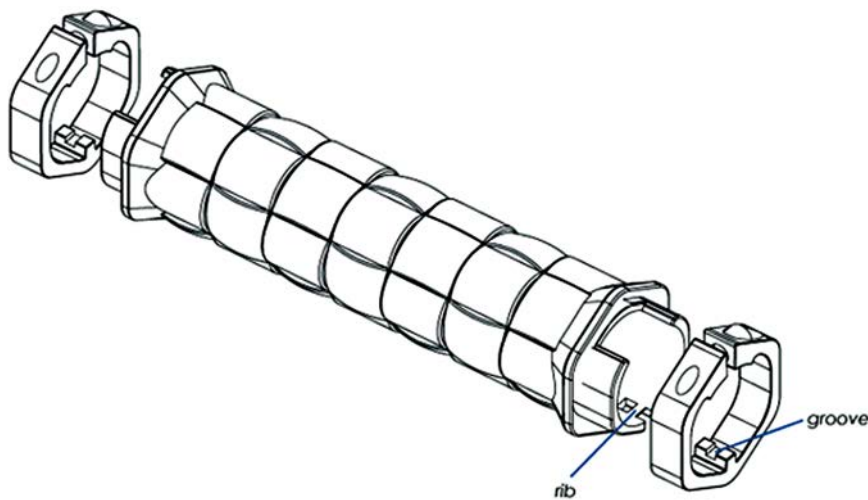



# Hexa-Ring Rubber Grips



## UG-601

w/Hexa-rings

Length: 130mm

Weight: 102g/pair

- Elegant profile match well to all kinds of high-end bicycles
- Interlaced vault pattern provide great traction while maintaining the comfort

- Comfortable feel and excellent shock absorption
- Durable compound for long lasting performance
- Deep grooves help channel away water and dirt, provides great control even in wet environments

## UG-602

w/Hexa-rings

Length: 130mm

Weight: 106g/pair



## UG-603

w/Hexa-rings

Length: 130mm

Weight: 118g/pair

- The raised soccer pattern makes the fingers & palm feel comfortable and provides excellent shock absorption
- The net texture provides great traction
- Hexagonal grip body provides additional traction and better control

- Comfortable feel and excellent shock absorption
- Durable compound for long lasting performance

## UG-604

w/Hexa-rings

Length: 130mm

Weight: 106g/pair



NEW

# Our Ergonomics

## **The Patent**

*The most common concern with selling ergonomic grips is the patent problem. UFOR developed these grips with new structure, elements & concept and got the patent in USA, Germany, China and Taiwan.*

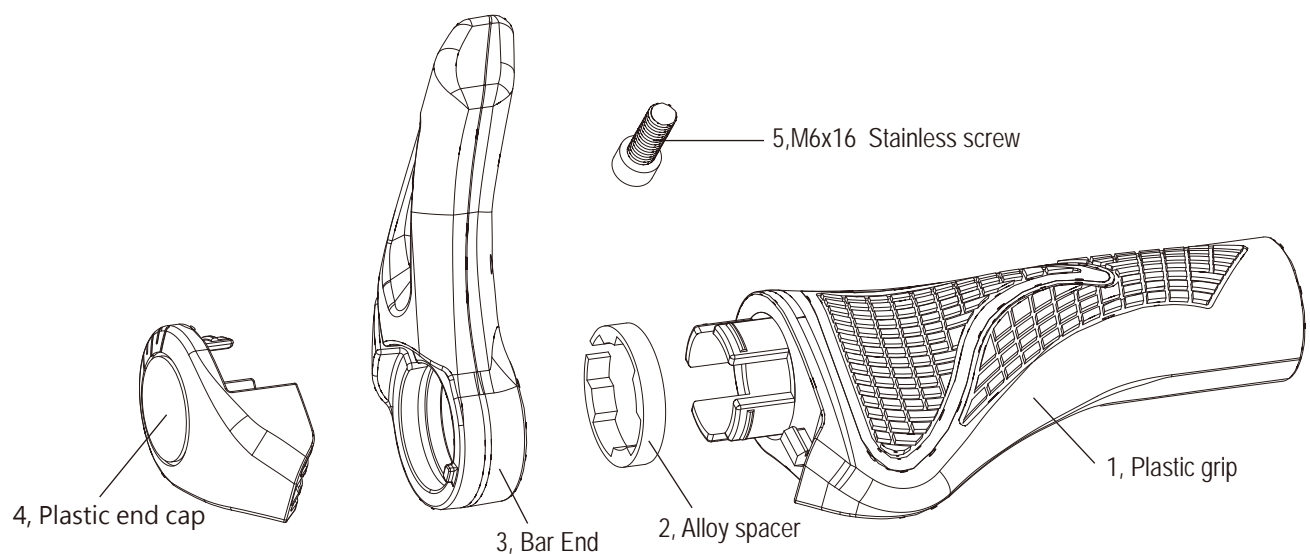
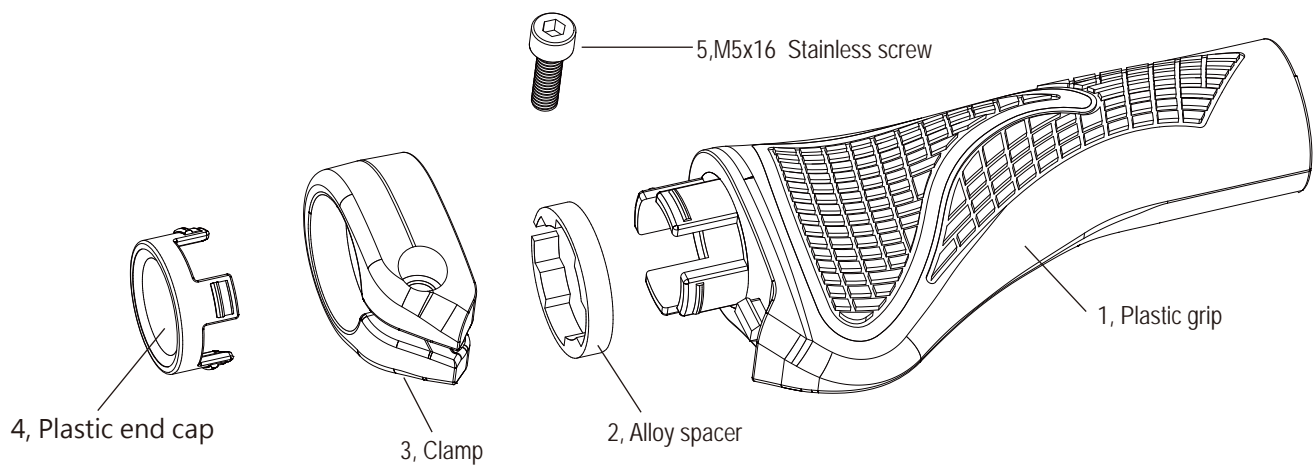

# Ergonomic Lock-On Rubber Grips



## **UG-101**

w/Aluminum Clamp  
Length: 130mm/97mm  
Weight: 171g/pair



## **UG-101B**

w/Adjustable Aluminum Bar End  
Length: 130mm/97mm  
Weight: 270g/pair



## **UG-102**

w/Aluminum Clamp  
Length: 130mm  
Weight: 193g/pair



## **UG-102B**

w/Adjustable Aluminum Bar End  
Length: 130mm  
Weight: 292g/pair

# Ergonomic Lock-On Cork Grips



## **UG-101C**

w/Aluminum Clamp  
Length: 130mm/97mm  
Weight: 175g/pair



## **UG-101BC**

w/Adjustable Aluminum Bar End  
Length: 130mm/97mm  
Weight: 274g/pair



## **UG-102C**

w/Aluminum Clamp  
Length: 130mm  
Weight: 193g/pair



## **UG-102BC**

w/Adjustable Aluminum Bar End  
Length: 130mm  
Weight: 292g/pair



# **DISTRIBUTOR** **WANTED**

**We are actively seeking to expand our distribution network worldwide. If you are interested in becoming our distributor, please do not hesitate to contact us.**

## Medical Aids - Wheelchair Parts



## Medical Equipment Parts



# CNC Products

## Bike Parts

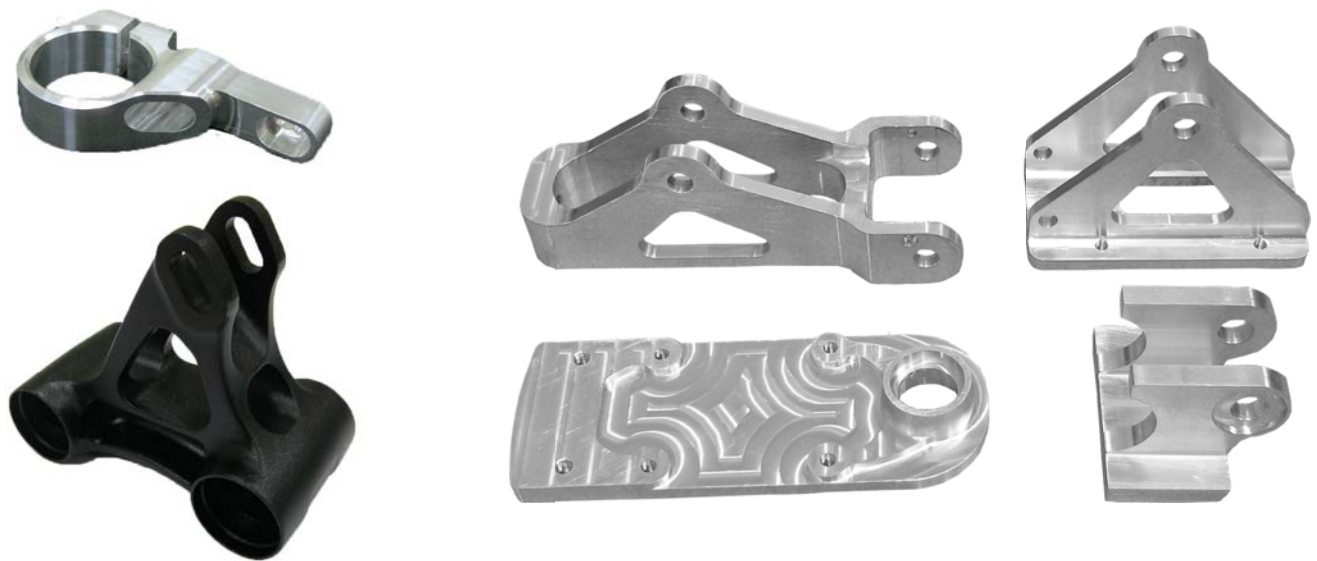

## E-Bike Parts



## Air Conditioner Compressor Parts





## Air-conditioner Compressor Housing

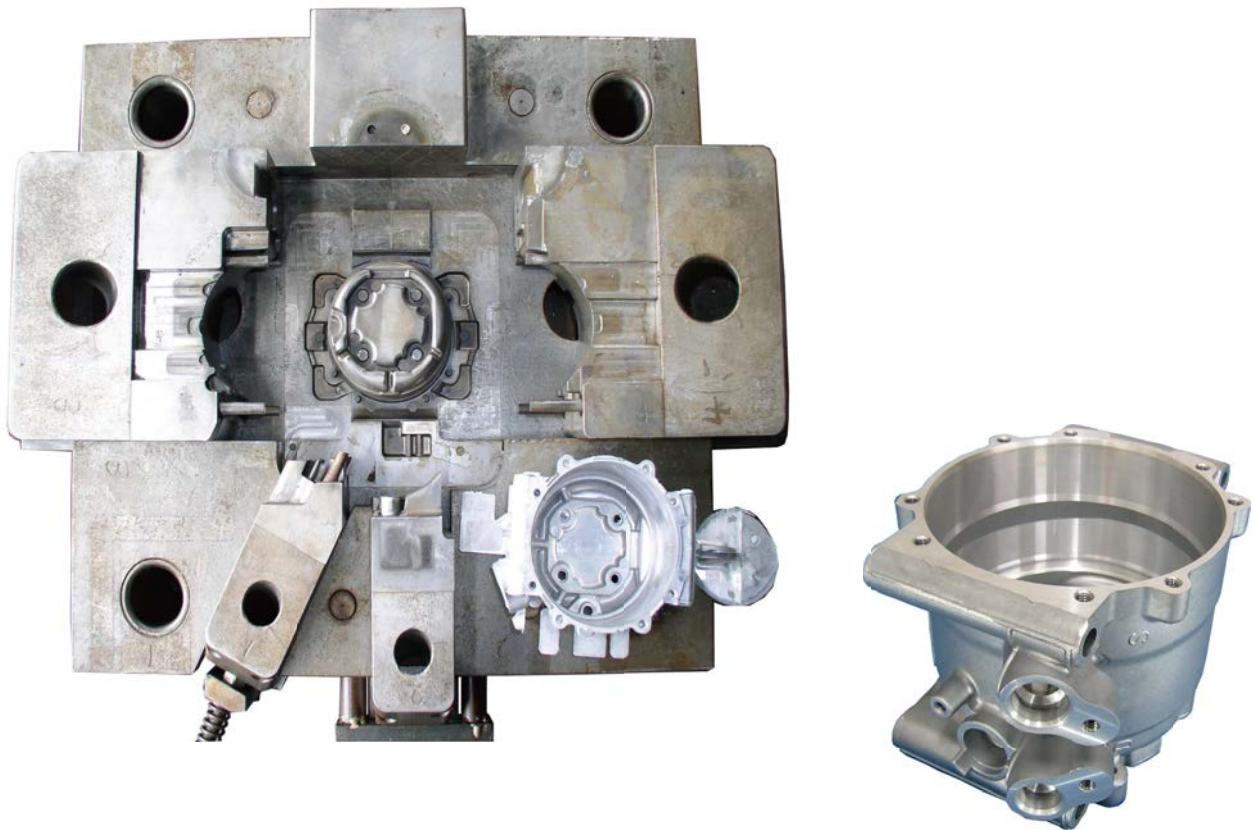

## Bike Pedals - Magnesium Die Casting Mold

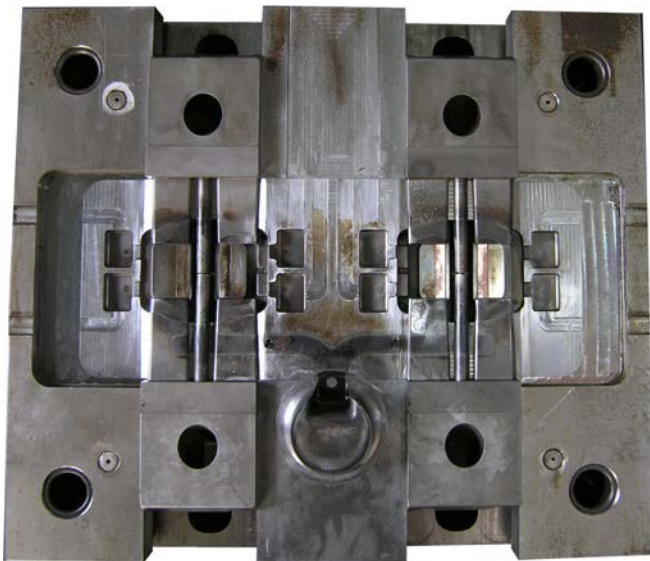



# Molds

## Automobile Motor Cooling Fan

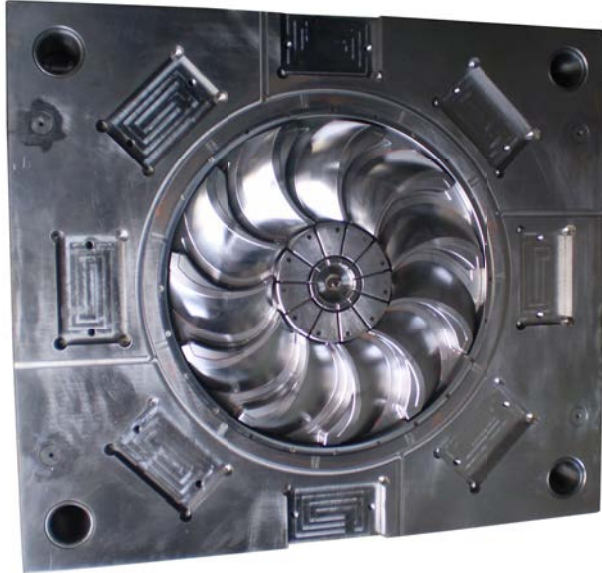

## Automobile Motor Cooling Fan

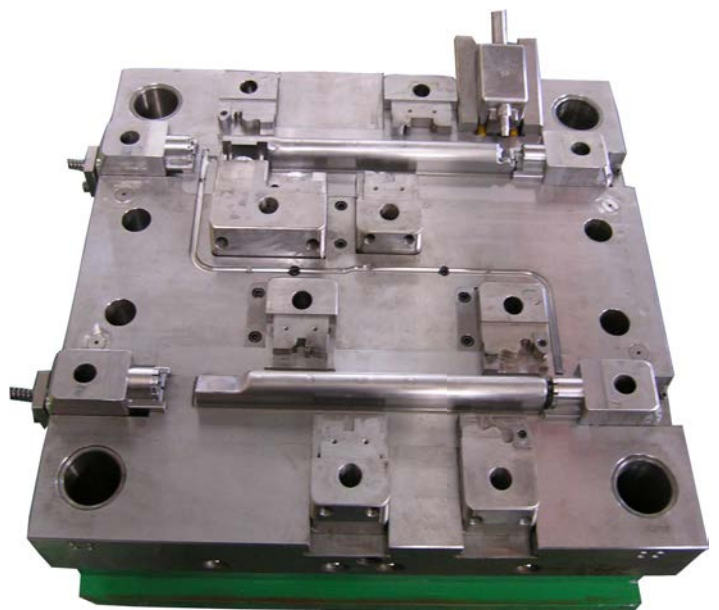

## Magnesium Die Casting Mold

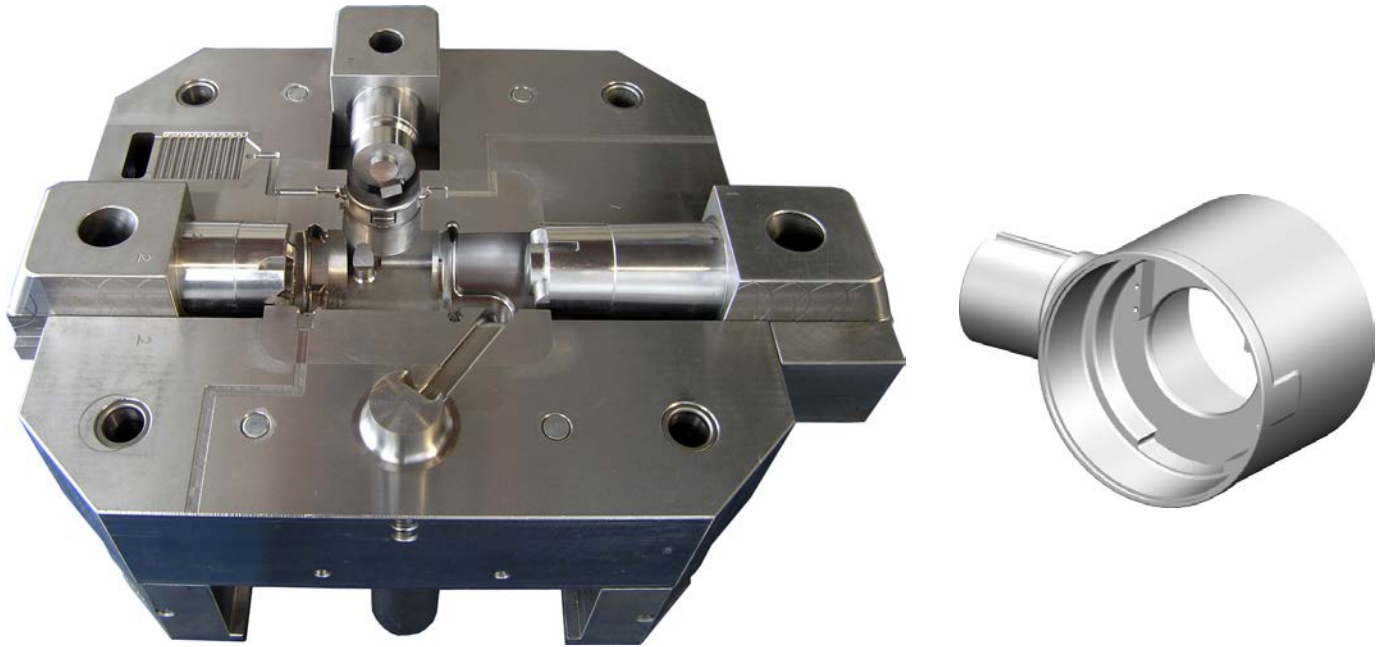

## Hot Chamber Zinc Die Casting





## **UFOR ENTERPRISE CO., LTD.**

No.42, Dongsi 5th Rd., Da-an Dist., Taichung City 439, Taiwan

Tel: 886 4 2461 6090    Fax: 886 4 2676 1786

[www.ufor.com.tw](http://www.ufor.com.tw)    e-mail: [sales@ufor.com.tw](mailto:sales@ufor.com.tw)